

Size range: 1/4" - 1/2"

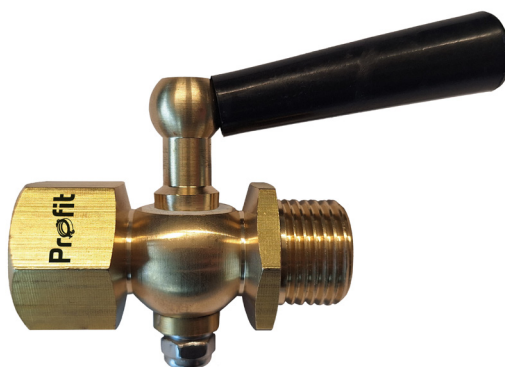

The pressure gauge valve PGV, is a plug valve that can be used to activate or isolate a pressure gauge or other instrument from a pressurised system. The valve can also be used to vent trapped pressure through the vent hole. This valve is used for maintaining or reading of instruments, not for throttling.

Characteristics

- Handle: lever.
- Female / female or male / female connection possible.
- Axis: antileak system.
- IP protection: IP56.
- Threaded connection: 1/4" BSP, 3/8" BSP, 1/2" BSP.
- Produced according to DIN 16261.

Working pressure

Maximum nominal pressure:
2,50 MPa / 25 bar / 363 psi.

Working temperature

-20°C to +50°C (without steam).

WARNING

Freezing of any fluid in the valve may severely damage the valve.

Material specifications

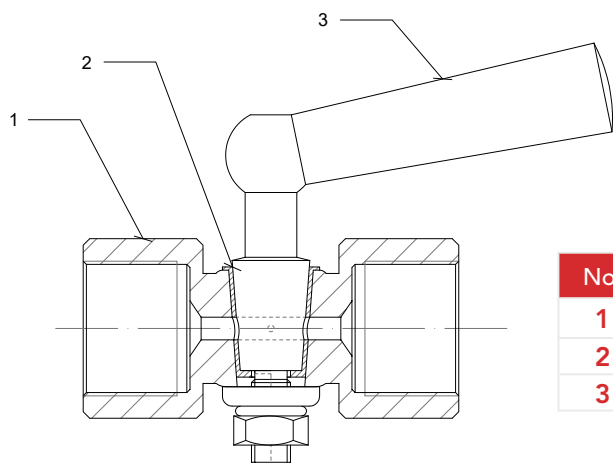

No.	Part description	QTY	Material
1	Nickel plated brass body + stem	1	CW617N
2	Seat bearing	1	PTFE
3	Handle	1	HDPE

Description	Ref Profit	Thread size	Weight (kg)
Pressure gauge valve PN25 1/4" BSP Female-Female*	PGV14-FF	1/4" BSP	0,105
Pressure gauge valve PN25 3/8" BSP Female-Female*	PGV38-FF	3/8" BSP	0,103
Pressure gauge valve PN25 1/2" BSP Female-Female*	PGV12-FF	1/2" BSP	0,150
Pressure gauge valve PN25 1/4" BSP Male-Female*	PGV14-MF	1/4" BSP	0,110
Pressure gauge valve PN25 3/8" BSP Male-Female*	PGV38-MF	3/8" BSP	0,134
Pressure gauge valve PN25 1/2" BSP Male-Female	PGV12-MF	1/2" BSP	0,145

*Not a stock item: delivery times on request.

Dimensions

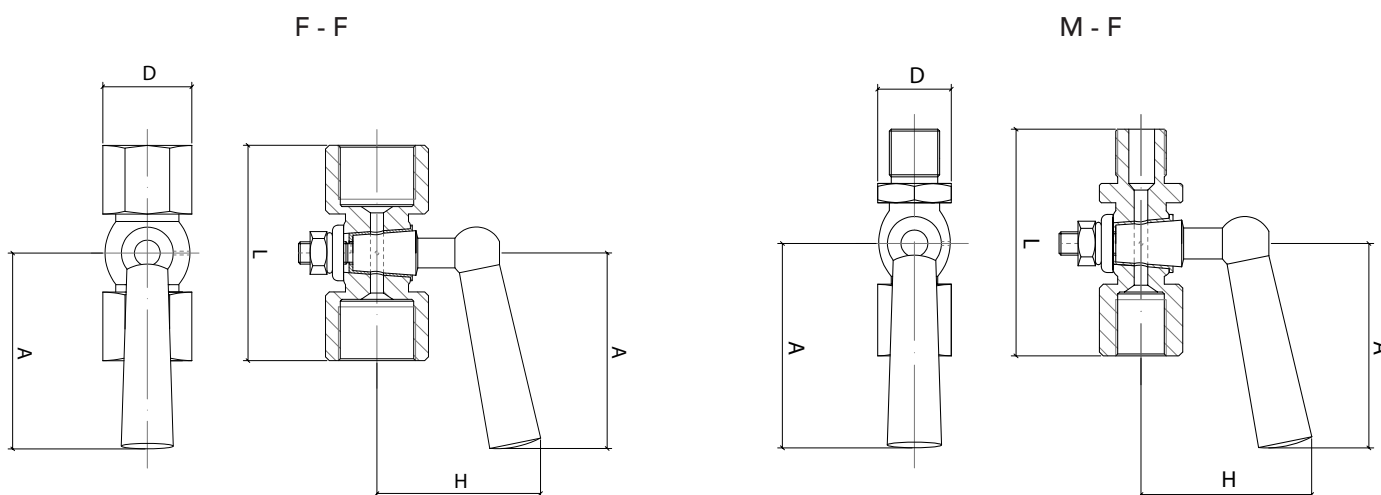

Profit		Thread	A	H	L	D key width
F-F	PGV14-FF	¼" BSP	52,7	44	51	19
	PGV38-FF	⅜" BSP			58	21
	PGV12-FF	½" BSP			59	24
M-F	PGV14-MF	¼" BSP			58,5	19
	PGV38-MF	⅜" BSP			58,5	21
	PGV12-MF	½" BSP			60	24

Installation, maintenance & operating instructions

Use:

This product may be used with WATER, AIR, GAS and OILS within pressure and temperature limits stated in this technical datasheet. Make sure the pressure gauge cock is compatible with the fluids in your system (e.g., liquids, gases). Check the manufacturer's specifications for compatible media.



Receiving and storage

- Inspect valves upon receipt for damage in shipment.
 - Handle all valves carefully without dropping.
 - Valves should remain boxed, clean and dry until installed to prevent weather related damage.
- For long term storage greater than six months, the valve must remain in the box and stored indoors.



Installation

- Products must be installed exclusively by qualified personnel and strictly following the instructions below. All installations must be performed in accordance with local regulations.
- Apply appropriate thread sealant to the threads of the valve ports according to the pipe material and fluid type.
- Install the valve into the piping system. Ensure the valve is oriented correctly for proper flow direction.
- Ensure the system pressure is within the rated pressure of the valve of 25 bar, and slowly open the pressure towards the installed valve with the valve in the venting position. When the water is appearing, the valve should be turned in the open position so the pressure can reach the pressure gauge.
- When the pressure gauge shows the wanted pressure, check the valve on leaks. If there is a leak visible around the area of the axis, tighten the nut carefully. If the nut is tightened too much the handle can get stuck. The handle should always be able to be turned by hand. Do not use tools to extend the handle, as excessive force might damage this handle. Overtightening can damage the threads, while under-tightening can cause leaks.

Operation

Before operating the pressure gauge cock, ensure the system pressure has been safely relieved according to appropriate procedures. Never exceed the maximum pressure rating of the pressure gauge cock of 25 barg.

- **Open:** turn the handle to the "Open" position to allow pressure to flow to the gauge, without venting.
- **Isolating the gauge:** turn the handle to the position to isolate the gauge from the system pressure. The pressure will be trapped between the valve and the system. It is not recommended to leave it in this position, since this can give a false reading of the pressure gauge
- **Venting the system:** turn the handle to the position to for venting from the side of the system pressure. The pressure will be trapped between the valve and the pressure gauge. It is not recommended to leave it in this position, since this can give a false reading of the pressure gauge
- **Venting:** if you wish to release the trapped pressure, turn the handle to the "Vent" position. The pressure will be released from the gauge through the vent port to the atmosphere.

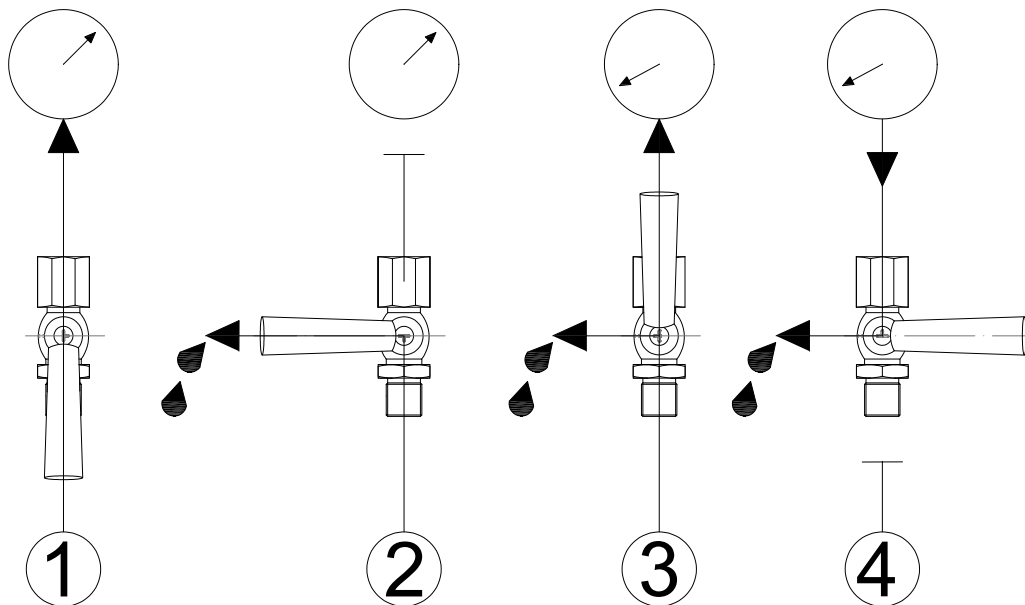

Maintenance

Inspect the valve regularly for leaks or damage. If there is a leak visible around the area of the axis, tighten the nut carefully. If the nut is tightened to much the handle can get stuck. The handle should always be able to be turned by hand. Do not use tools to extend the handle, as excessive force might cause damage. Overtightening can damage the threads, while under-tightening can cause leaks.

Replace the valve if it shows signs of wear or malfunction.

GENERAL INFO

- Installers should be trained or experienced to install and understand the product.
- Read and understand all technical datasheets and installation instructions before attempting to install, remove or adjust any Profit piping products.
- Depressurise and drain the sprinkler installation system before attempting to install, remove or adjust any Profit piping products.
- Never work on piping systems that are pressurised and / or filled with water.
- Piping Logistics reserves the right to change specifications, designs and / or standard equipment without notice and without incurring in any obligations.
- Use the necessary Personal Protection Equipment (PPE) to avoid personal injury (helmet, safety shoes and goggles, Profit gloves).



Failure to follow these instructions could result in death or serious injury and property damage.

We advise to always store our products in closed and dry environments, the products do not need any specific maintenance once installed on an aboveground sprinkler installation.

REVISION TABLE

Date	△	Notes
10/06/2024		Initial release.